

Addendum No. 1

BID NO. 2024-090290145

EULESS GRAPEVINE RD WIDENING

Federal Aid Project CM 2021(970)

TXDOT CSJ 0902-90-145



Bid Opening: 2:00 pm, Tuesday, May 13th, 2024
City of Grapevine
200 S. Main Street
Grapevine, TX 76051

TO: All Plan Holders of Record

This Addendum modifies the plans and bid documents dated June 25, 2024, as noted within, and shall become part of the contract documents. Bidders shall acknowledge receipt of the Addendum in the space provided on the Bid Form and on the outer envelope of the Bid Proposal. Failure to acknowledge receipt of this Addendum may subject the bidder to disqualification.

Replacement sheets have been included with this Addendum under Attachment A.

Contract:

1. Removed TxDOT Special Provisions SP 000-003L and SP 000-020L
 - a. Updated the following sheets to reflect the removal of the above Special Provisions:
 - Table of Contents
 - TxDOT Specs and Provisions List
 - Contractor's Assurance
2. Updated Table of Contents page numbers
3. Updated Paul Lee's email address in Notice to Contractor's

Plans:

1. Updated Title Sheet to reflect the following:
 - a. Updated TDLR Project Number
 - b. Sheet Index showing Title Sheet and Index of Sheets
 - c. Specifications note to reflect updated Specification Date of September 1, 2024

Questions:

1. The pre-bid is 4/8 and the QA deadline shows as 4/11. Is the bid date actually 5/13 or 4/13?

Answer: The bid date is May 13, 2025.

2. Is there an Engineer's Estimate available for this project?

Answer: Engineer's Estimate has been added to the Documents on CivCast.

3. Regarding line items #666 "RE PROFILE PM TY I (W)4"(SLD)","RE PROFILE PM TY I (Y)4"(SLD)" "RE PROFILE PM TY I (W)4"(BRK)"; I noticed the specification states "PROFILE." Would extruded thermoplastic be an acceptable method for the installation of these items? Please confirm if this meets project requirements.

Answer: The construction/installation method shall meet the requirements set forth in TxDOT Specification Item 666.

4. Can you share the pre-bid meeting minutes?

Answer: Pre-bid agenda and attendees will be shared as well as questions asked during the meeting.

5. Can you extend the QA cutoff date another 3 weeks? Not enough time to ask valuable/cost saving questions.

Answer: The QA cutoff remains as is, April 11th.

6. Who is in charge of survey and quality control?

Answer: The City of Grapevine will take care of quality control. Refer to Item 5L Section 9 in the Project Manual for direction on survey.

7. When will the project start?

Answer: The goal is to start as soon as a letter of concurrence from TxDOT is received, and a City Council Meeting is conducted.

8. Are there any owner-furnished materials on the job?

Answer: No, but there are special specifications that should be reviewed within the Project Manual.

9. How is the work week defined?

Answer: The work week is defined as a Standard Workweek. Refer to Item 8L Section 3.1.4 in the Project Manual.

ATTACHMENT A

TABLE OF CONTENTS

PROPOSAL DOCUMENTS

A. PROPOSAL TO BID.....	3
B. PROPOSAL SHEETS.....	5
C. PROPOSAL SUMMARY SHEET.....	19
D. CONTRACT.....	23
E. BONDS.....	30
F. INSURANCE.....	35
G. DBE REQUIREMENTS.....	37

CONTRACT DOCUMENTS

H. NOTICE TO CONTRACTORS.....	39
I. ENGINEERS' CERTIFICATION.....	42
J. GENERAL NOTES.....	44
K. INDEX OF GOVERNING STANDARD SPECIFICATIONS, SPECIAL PROVISIONS & SPECIAL SPECIFICATIONS.....	56
L. LOCAL GOVERNMENT GENERAL REQUIREMENTS AND COVENANTS.....	60
• ITEM 1L: ABBREVIATIONS AND DEFINITIONS	
• ITEM 2L: INSTRUCTIONS TO BIDDERS	
• ITEM 3L: AWARD AND EXECUTION OF CONTRACT	
• ITEM 4L: SCOPE OF WORK	
• ITEM 5L: CONTROL OF THE WORK	
• ITEM 6L: CONTROL OF MATERIALS	
• ITEM 7L: LEGAL RELATIONS AND RESPONSIBILITIES	
• ITEM 8L: PROSECUTIONS AND PROGRESS	
• ITEM 9L: MEASUREMENT AND PAYMENT	
M. SPECIAL PROVISIONS: FEDERAL-AID CONSTRUCTION CONTRACTS.....	127
• FHWA-1273 – REQUIRED CONTRACT PROVISIONS.	
• FHWA-1273 – WAGE RATES.	
• CONTRACTOR CERTIFICATIONS	
• CHILD SUPPORT STATEMENT	
• PROHIBITION ON CERTAIN TELECOMMUNICATIONS EQUIPMENT OR SERVICES	
• SP 000-001L – NONDISCRIMINATION	
• SP 000-002L – CERTIFICATION OF NONDISCRIMINATION IN EMPLOYMENT.	
• SP 000-007L – CARGO PREFERENCE ACT REQUIREMENTS IN FEDERAL AID PROJECTS.	
• SP 000-018L – SCHEDULE OF LIQUIDATED DAMAGES.	
• SP 000-394L – DISADVANTAGED BUSINESS ENTERPRISE IN FEDERAL AID CONTRACTS.	
• SP 006-001L – CONTROL OF MATERIALS.	
• SP 506-001L – TEMPORARY EROSION, SEDIMENTATION, AND ENVIRONMENTAL CONTROLS.	

- SS 5042 – ADJUST FIRE HYDRANT.
- SS 5046 – RECESSED INLETS.
- SS 5043 – BARRIER FREE RAMP TYPE ‘C’.
- SS 6086 – DUCTED COMMUNICATION CABLE.
- SS 6088 – EMERGENCY VEHICLE PEEMPTION DETECOR.
- SS 6091 – 350 ATC TRAFFIC CONTROLLER CABINET.
- SS 6092 – COMMANDER ATC RACK MOUNT.

N. SPECIAL PROVISIONS: STATE/FEDERAL REQUIREMENTS.....188

O. APPENDIX.....208

- APPENDIX A: TREE PRESERVATION
- APPENDIX B: WATER SHUT OFF POLICY
- APPENDIX C: EROSION AND SEDIMENT CONTROL
- APPENDIX D: PREAMBLE TO RULE 110.110

**CITY OF GRAPEVINE
TARRANT COUNTY, TEXAS
INDEX OF GOVERNING SPECIFICATIONS AND SPECIAL PROVISIONS**

**FOR THE CONSTRUCTION OF
EULESS GRAPEVINE RD WIDENING
GRAPEVINE, TEXAS**

STANDARD SPECIFICATIONS: ADOPTED BY THE TEXAS DEPARTMENT OF TRANSPORTATION SEPTEMBER 1, 2024. STANDARD SPECIFICATIONS ARE INCORPORATED INTO THE CONTRACT BY REFERENCE.

ITEM 1	ABBREVIATIONS AND DEFINITIONS
ITEM 2	INSTRUCTIONS TO BIDDERS
ITEM 3	AWARD AND EXECUTION OF CONTRACT
ITEM 4	SCOPE OF WORK
ITEM 5	CONTROL OF THE WORK
ITEM 6	CONTROL OF MATERIALS
ITEM 7	LEGAL RELATIONS AND RESPONSIBILITIES
ITEM 8	PROSECUTION AND PROGRESS
ITEM 9	MEASUREMENT AND PAYMENT
ITEM 100	PREPARING ROW
ITEM 104	REMOVING CONCRETE
ITEM 105	REMOVING TREATED AND UNTREATED BASE AND ASPHALT PAVEMENT
ITEM 110	EXCAVATION
ITEM 132	EMBANKMENT
ITEM 260	LIME TREATMENT (ROAD-MIXED)
ITEM 341	DENSE-GRADED HOT-MIX ASPHALT
ITEM 360	CONCRETE PAVEMENT
ITEM 361	FULL-DEPTH REPAIR OF CONCRETE PAVEMENT
ITEM 416	DRILL SHAFT FOUNDATIONS
ITEM 420	CONCRETE SUBSTRUCTURES
ITEM 432	RIPRAP
ITEM 464	REINFORCED CONCRETE PIPE
ITEM 465	JUNCTION BOXES, MANHOLES, AND INLETS
ITEM 466	HEADWALLS AND WINGWALLS
ITEM 479	ADJUSTING MANHOLES AND INLETS
ITEM 500	MOBILIZATION
ITEM 502	BARRICADES, SIGNS, AND TRAFFIC HANDLING
ITEM 503	PORTABLE CHANGEABLE MESSAGE SIGN
ITEM 505	TRUCK-MOUNTED ATTENUATOR (TMA) AND TRAILER ATTENUATOR (TA)
ITEM 529	CONCRETE CURB, GUTTER, AND COMBINED CURB AND GUTTER
ITEM 512	PORTABLE TRAFFIC BARRIER
ITEM 531	SIDEWALKS
ITEM 536	CONCRETE MEDIANS AND DIRECTIONAL ISLANDS
ITEM 542	REMOVE METAL BEAM GUARD FENCE

- ITEM 618 CONDUIT
- ITEM 620 ELECTRICAL CONDUCTORS
- ITEM 624 GROUND BOXES
- ITEM 628 ELECTRICAL SERVICES
- ITEM 644 SMALL ROADSIDE SIGN ASSEMBLIES
- ITEM 662 WORK ZONE PAVEMENT MARKINGS
- ITEM 666 RETROREFLECTORIZED PAVEMENT MARKINGS
- ITEM 672 RAISED PAVEMENT MARKERS
- ITEM 678 PAVEMENT SURFACE PREPARATION FOR MARKINGS
- ITEM 680 HIGHWAY TRAFFIC SIGNALS
- ITEM 682 VEHICLE AND PEDESTRIAN SIGNAL HEADS
- ITEM 684 TRAFFIC SIGNAL CABLES
- ITEM 686 TRAFFIC SIGNAL POLE ASSEMBLIES
- ITEM 687 PEDESTAL POLE ASSEMBLIES
- ITEM 688 PEDESTRIAN DETECTORS AND VEHICLE LOOP DETECTORS
- ITEM 690 MAINTENANCE OF TRAFFIC SIGNALS

SPECIAL PROVISIONS: SPECIAL PROVISIONS WILL GOVERN AND TAKE PRECEDENCE OVER THE STANDARD SPECIFICATIONS ENUMERATED HEREON WHEREVER IN CONFLICT THEREWITH.

TXDOT:

- SPECIAL PROVISION TO ITEM 000 (000-001L) (000-002L) (000-007L) (000-018L) (000-394L)
- SPECIAL PROVISION TO ITEM 6L (006-001L)
- SPECIAL PROVISION TO ITEM 506 (506-001L)

REQUIRED CONTRACT PROVISIONS, FEDERAL-AID CONSTRUCTION CONTRACTS (FORM FHWA 1273, OCT 2023)

WAGE RATES (FORM FHWA 1273, OCT 2023)

CONTRACTOR CERTIFICATIONS

CHILD SUPPORT STATEMENT

PROHIBITION ON CERTAIN TELECOMMUNICATIONS EQUIPMENT OR SERVICES

CITY OF GRAPEVINE:

NORTH CENTRAL TEXAS COUNCIL OF GOVERNMENTS STANDARD SPECIFICATIONS, CITY OF GRAPEVINE SPECIAL PROVISIONS TO THE NCTCOG STANDARD SPECIFICATIONS, AND CITY OF GRAPEVINE STANDARD DETAILS ARE INCORPORATED INTO THE CONTRACT BY REFERENCE.

SPECIAL SPECIFICATIONS:

TXDOT:

SPECIAL SPECIFICATION 5042
SPECIAL SPECIFICATION 5043
SPECIAL SPECIFICATION 5046
SPECIAL SPECIFICATION 6086
SPECIAL SPECIFICATION 6088
SPECIAL SPECIFICATION 6091
SPECIAL SPECIFICATION 6092

ADJUST FIRE HYDRANT
BARRIER FREE RAMP TYPE 'C'
RECESSED INLETS
DUCTED COMMUNICATION CABLE
EMERGENCY VEHICLE PREEMPTION DETECTOR
350 ATC TRAFFIC CONTROLLER CABINET
COMMANDER ATC RACK MOUNT

GENERAL: THE ABOVE-LISTED SPECIFICATION ITEMS ARE THOSE UNDER WHICH PAYMENT IS TO BE MADE. THESE, TOGETHER WITH SUCH OTHER PERTINENT ITEMS, IF ANY, AS MAY BE REFERRED TO IN THE ABOVE-LISTED SPECIFICATION ITEMS, AND INCLUDING THE SPECIAL PROVISIONS LISTED ABOVE, CONSTITUTE THE COMPLETE SPECIFICATIONS FOR THIS PROJECT.

CONTRACTOR'S ASSURANCE

(Subcontracts-Federal Aid Projects)

By signing this proposal, the contractor is giving assurances that all subcontract agreements will incorporate the Standard Specification and Special Provisions to Section 9.9., Payment Provisions for Subcontractors, all subcontract agreements exceeding \$2,000 will incorporate the applicable Wage Determination Decision, and all subcontract agreements will incorporate the following:

Special Provision	Certification of Nondiscrimination in Employment
Special Provision	Standard Federal Equal Employment Opportunity
Form FHWA 1273	Required Contract Provisions Federal-aid Construction Contracts (Form FHWA 1273 must also be physically attached to subcontracts and all lower-tier subcontracts)
Special Provision	Nondiscrimination (Include provisions of Sections 3.1 – 3.6 in all subcontracts and agreements for materials)
Special Provision	Cargo Preference Act Requirements in Federal-Aid Contracts
Special Provision	Disadvantaged Business Enterprise in Federal-Aid Contracts

NOTICE TO CONTRACTORS

1st Advertisement: March 30, 2025

2nd Advertisement: April 6, 2025

Sealed proposals addressed to:

Bryan Beck, PE - Director of Public Works
City of Grapevine, Texas

will be received at:

Physical Address:

Grapevine City Hall
200 South Main Street
Grapevine, Texas 76051

Mailing Address:

Grapevine City Hall
P.O. Box 95104
Grapevine, Texas 76099

until 2:00 PM Tuesday, May 13, 2025 for the:

Eules Grapevine Rd Widening

Construction of pavement to transition from a four-lane roadway section at SH 360 and Eules Grapevine Rd to a two-lane section at Hughes Rd and Eules Grapevine Rd. Construct a sidewalk on the west side of the roadway, update existing pedestrian elements to meet ADA compliance, and update the drainage system to accommodate the wider pavement and sidewalk. Install new traffic signals at the SH 360/Eules Grapevine intersection as well as new pedestrian push button and crosswalks. The major components of this work include pavement, sidewalk, reinforced concrete pipes, and traffic signal elements.

Immediately following the time for receipt of bids, the proposals will be publicly opened and read aloud in the second floor conference room of the Grapevine City Hall, as addressed above. Any bid received after the above time and date will be returned unopened.

Contract Documents, including Plans and Specifications, may be examined without charge in the:

Public Works Dept./Engineering Division
City Hall
200 South Main Street
Grapevine, Texas 76051

beginning on March 31, 2025 after 12:00 PM. Further information regarding this project may be obtained by contacting Paul Lee, PE at 817-410-3144 or by email plee@grapevintexas.gov.

A digital copy of the contract documents, including plans and specifications, may be procured from the Engineer for \$25.00 per USB:

LJA Engineering, Inc.
Zachary S. Vermillion, PE
zvermillion@lja.com

on March 31, 2025 after 12:00 PM.

A non-mandatory Pre-Bid Conference, will be held at 2:00 PM, Tuesday, April 8, 2025, in the second floor conference room of the Grapevine City Hall, as addressed above. This conference is for the purpose of interpretation for bidding contractors of the Contract Documents, including plans and specifications, for construction of the project.

The deadline for the City receiving questions shall be Friday, April 11, 2025 at 5:00 PM.

To be accepted, a bid must be accompanied by a bid security instrument payable to the City of Grapevine, Texas, in an amount not less than five (5%) percent of the total base bid, in the form of either (a) a cashier's check or certified check on a Texas bank or thrift with FDIC insurance or (b) an acceptable bidder's bond with a surety authorized to operate in the State of Texas.

Performance and Payment Bonds will be required.

In case of ambiguity or lack of clearness in stating bid/proposal prices, the City of Grapevine reserves the right to adopt the most advantageous construction thereof, to reject any or all bids, and to waive formalities. No bid may be withdrawn within ninety (90) days after the date on which bids are opened.

CITY OF GRAPEVINE
Bryan Beck, PE
Director of Public Works

END OF NOTICE

SHEET NO.	DESCRIPTION
1	TITLE SHEET
2	INDEX OF SHEETS

FINAL PLANS

NAME OF CONTRACTOR: _____
 DATE OF LETTING: _____
 DATE WORK BEGAN: _____
 DATE WORK COMPLETED: _____
 DATE WORK ACCEPTED: _____
 SUMMARY OF CHANGE ORDERS: _____

**STATE OF TEXAS
 DEPARTMENT OF TRANSPORTATION**

**PLANS OF PROPOSED
 STATE HIGHWAY IMPROVEMENT**

FEDERAL AID PROJECT NO. CM 2021(970)

**EULESS-GRAPEVINE ROAD
 TARRANT COUNTY**

NET LENGTH OF ROADWAY = 906.50 FT. = 0.17 MI.
 NET LENGTH OF PROJECT = 2,189.50 FT. = 0.41 MI.

LIMITS: STATE HIGHWAY 360 SOUTHBOUND SERVICE ROAD TO APPROXIMATELY 150 FEET SOUTH OF HUGHES ROAD INTERSECTION.

FOR THE CONSTRUCTION OF THE WIDENING OF EULESS-GRAPEVINE ROAD FROM TWO TO THREE LANES.

CONSISTING OF THE INSTALLATION OF A NEW TRAFFIC SIGNAL AT THE INTERSECTION OF THE STATE HIGHWAY 360 SOUTHBOUND FRONTAGE ROAD.

FEDERAL AID PROJECT NO.			
CM 2021(970)			
CONT	SECT	JOB	HIGHWAY
0902	90	145	SH 360
DIST	COUNTY		SHEET NO.
FTW	TARRANT		1

DESIGN SPEED = 30 MPH
 A.D.T. (2014) = 4,285
 A.D.T. (2019) = 4,367

TDLR Project Number: TABS2024010540
 FUNCTIONAL CLASSIFICATION: MAJOR COLLECTOR

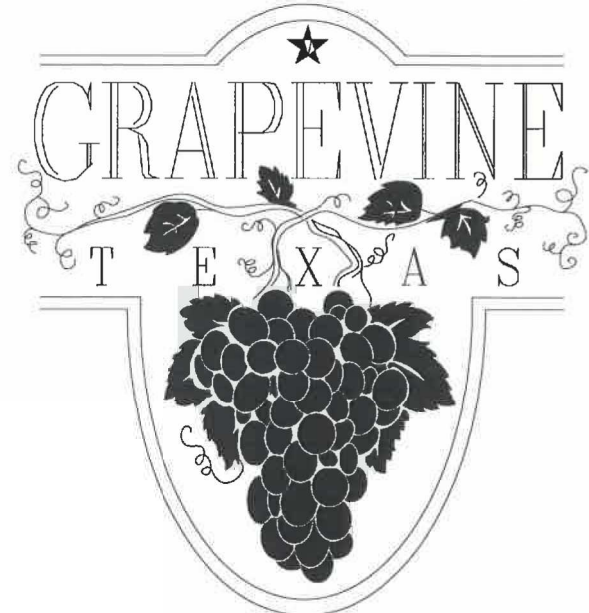

PAUL M. LEE, P.E.
 PHONE 817.410.3136
 EMAIL PLEE@GRAPEVINETEXAS.GOV

VICINITY MAP

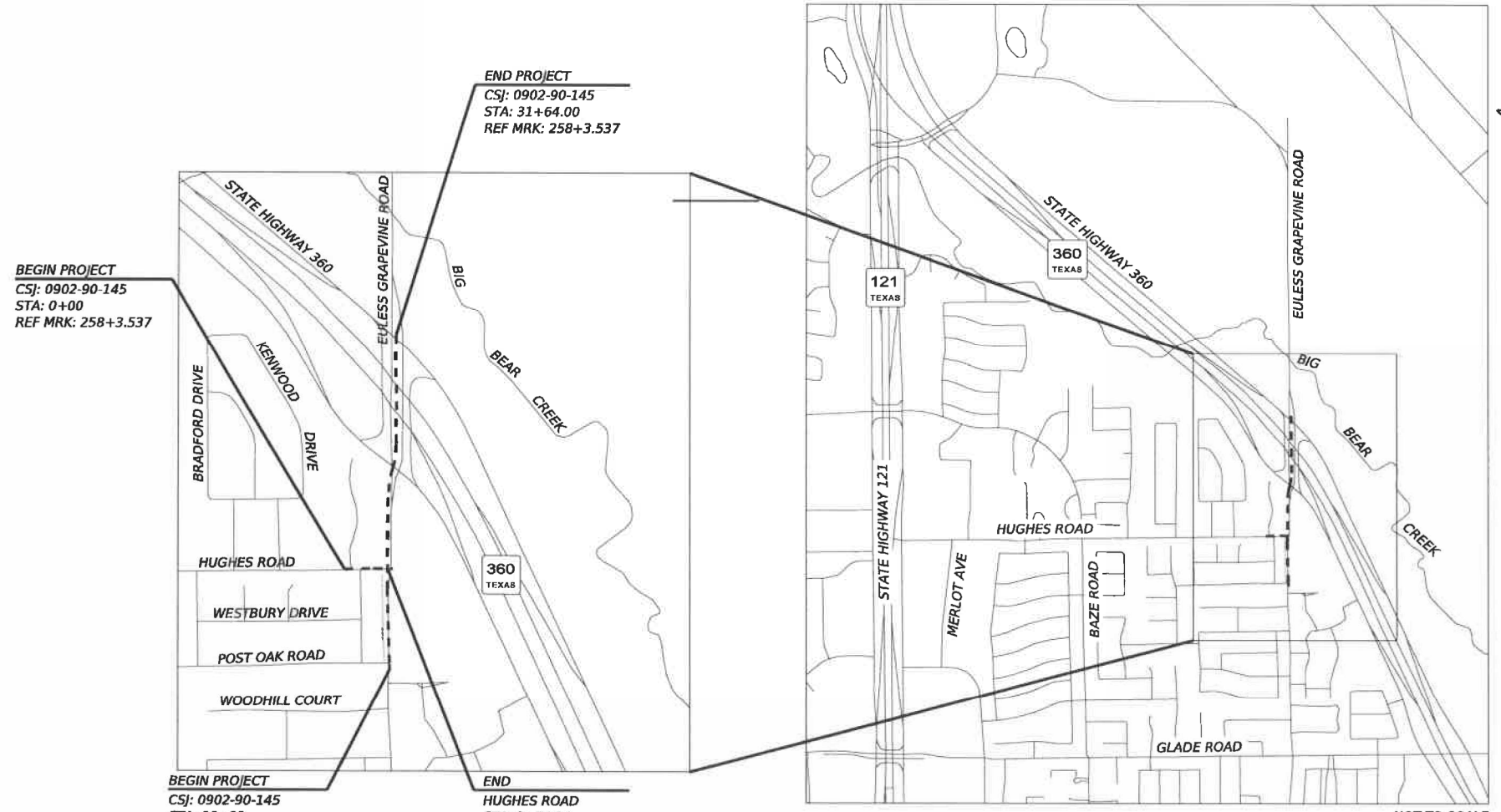

BEGIN PROJECT
 CSJ: 0902-90-145
 STA: 0+00
 REF MRK: 258+3.537

END PROJECT
 CSJ: 0902-90-145
 STA: 31+64.00
 REF MRK: 258+3.537

BEGIN PROJECT
 CSJ: 0902-90-145
 STA: 10+00
 REF MRK: 258+3.537

END
 HUGHES ROAD
 STA: 2+74.94
 EULESS GRAPEVINE ROAD
 STA: 16+45.92

EXCEPTIONS: NONE
 EQUATIONS: NONE

NOT TO SCALE

SPECIFICATIONS ADOPTED BY THE TEXAS DEPARTMENT OF TRANSPORTATION, SEPTEMBER 1, 2024 AND SPECIFICATION ITEMS LISTED AND DATED AS FOLLOWS, SHALL GOVERN ON THIS PROJECT: REQUIRED CONTRACT PROVISIONS FOR ALL FEDERAL-AID CONSTRUCTION CONTRACTS (FORM FHWA 1273, OCTOBER 2023)

REQUIRED SIGNS SHALL BE IN ACCORDANCE WITH BC (1)- 21 THRU BC (12)- 21 AND THE "TEXAS MANUAL ON UNIFORM TRAFFIC CONTROL DEVICES".

SUBMITTED FOR LETTING: 06/25/24

 PROJECT MANAGER

CONCURRENCE: 6/27/24

 CITY ENGINEER

CONCURRENCE: 6/27/24

 DIRECTOR OF PUBLIC WORKS

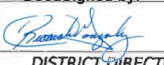

SUBMITTED FOR LETTING: 6/27/2024
 Designed by: 
 ANS060570F28477...

RECOMMENDED FOR LETTING: 6/28/2024
 District Director of Transportation Planning and Development

APPROVED FOR LETTING: 6/28/2024
 District Engineer
 David M Salazar, P.E.
 B741E64FAD82411...



LJA Engineering, Inc. LJA
 F01-F-1386

DATE: 6/25/2024 1:19:10 PM
 FILE: c:\working\tr\ia-pw\entview.com\ia-pw-01\jenifer_luna\dms2889145 TITLE01.dgn